

S022

Complex Structure Metal Series

INFORMATION ABOUT PRODUCT

Minimum Space	660x358x380 cm
Impact Protection net	19,20 m ²
Dimensions	310x58 cm
Overall Height	200 cm
Free falling height	125 cm
Foundations	6 pcs
Availability of spare parts	YES
Product complies with EN 1176	YES
Age range	3-14
Amount of users	2

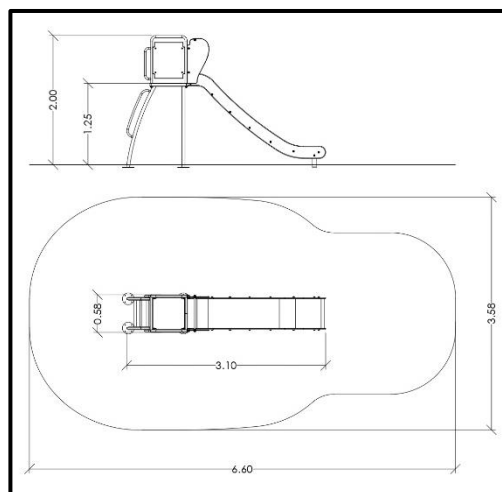

MATERIALS

- Posts (colored): Hot Dip Galvanized and powder coated Steel
- Posts (non - colored): Hot Dip Galvanized (plain) or Stainless Steel (304 / 316L)
- Floors: HPL Antiskid 12mm (EXT)
- Panels: HPL 12mm (EXT)
- Slide Side Panels / Panels that experience forces: HPL 18mm (EXT)
- Sliding Surface: GFRP (Glass Fiber Reinforced Polyester) t=4.5mm
- Metal Parts (colored): Hot Dip Galvanized and powder coated Steel
- Metal Parts (non - colored): Hot Dip Galvanized (plain) or Stainless Steel (304 / 316L)
- Steel Ropes apparatus: Steel core ropes braided with polypropylene (Ø16mm). Solid and aesthetic connectors made of injection molded durable plastic / end-connectors and sleeves made of durable aluminum alloy
- All other plastic elements: Fiber reinforced plastic
- Transparent Parts: Clear Polycarbonate material (t=5mm)
- Fasteners: Electroplated coated or Stainless Steel (304 / 316L)
- Chains: Hot Dip Galvanized (plain) or Stainless Steel (304 / 316L) / Ø6mm / According to DIN 766
- Step Modules: Manufactured of rotomoulded polyethylene develop process.



Please note that the above list of materials concerns the articles of the whole series. Therefore, some of them are not used in the described article.