

# S022G

## Complex Structure Metal Series

### INFORMATION ABOUT PRODUCT

Minimum Space	607x358x350 cm
Impact Protection net	17,60 m <sup>2</sup>
Dimensions	257x58 cm
Overall Height	170 cm
Free falling height	95 cm
Foundations	6 pcs
Availability of spare parts	YES
Product complies with EN 1176	YES
Age range	1,5-14
Amount of users	2

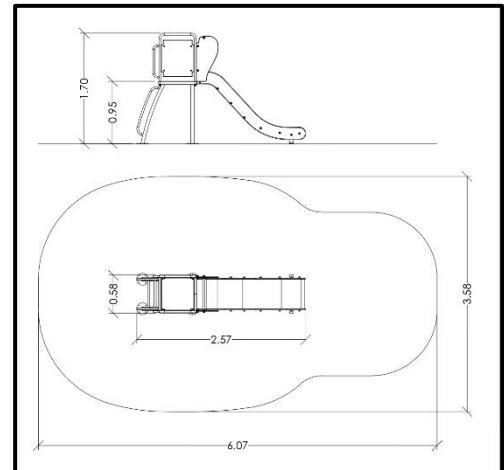

### MATERIALS

- Posts (colored): Hot Dip Galvanized and powder coated Steel
- Posts (non - colored): Hot Dip Galvanized (plain) or Stainless Steel (304 / 316L)
- Floors: HPL Antiskid 12mm (EXT)
- Panels: HPL 12mm (EXT)
- Slide Side Panels / Panels that experience forces: HPL 18mm (EXT)
- Sliding Surface: GFRP (Glass Fiber Reinforced Polyester) t=4.5mm
- Metal Parts (colored): Hot Dip Galvanized and powder coated Steel
- Metal Parts (non - colored): Hot Dip Galvanized (plain) or Stainless Steel (304 / 316L)
- Steel Ropes apparatus: Steel core ropes braided with polypropylene (Ø16mm). Solid and aesthetic connectors made of injection molded durable plastic / end-connectors and sleeves made of durable aluminum alloy
- All other plastic elements: Fiber reinforced plastic
- Transparent Parts: Clear Polycarbonate material (t=5mm)
- Fasteners: Electroplated coated or Stainless Steel (304 / 316L)
- Chains: Hot Dip Galvanized (plain) or Stainless Steel (304 / 316L) / Ø6mm / According to DIN 766
- Step Modules: Manufactured of rotomoulded polyethylene develop process.



***Please note that the above list of materials concerns the articles of the whole series. Therefore, some of them are not used in the described article.***