

CU02 (Standard) version

Complex structure CU Series

INFORMATION ABOUT PRODUCT

Minimum Space	828x660x400 cm
Impact Protection net	44,00 m ²
Dimensions	478x360 cm
Overall Height	403 cm
Free falling height	100 cm
Foundations	4 pcs
Availability of spare parts	YES
Product complies with EN 1176	YES
Age range	3-14
Amount of users	20

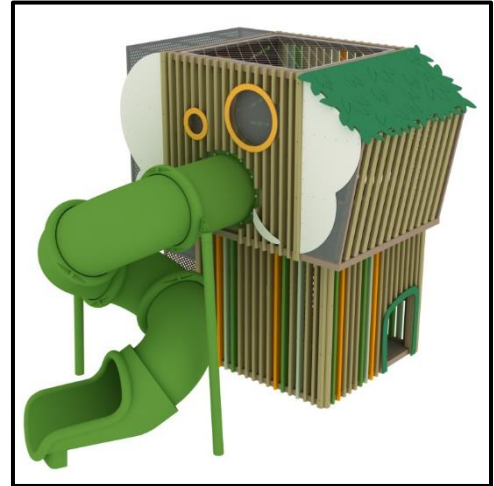

MATERIALS

- Metal Parts (coated): 2 layers consists of Water based primer and color lacquered paint.
- Floors: HPL Anti-slip 12mm (EXT)
- Panel Facades: Pine Wood
- Decorative Panels: HPL 12mm (EXT)
- Tube slides: Rotomolded modular species made of Heavy-duty Plastic.
- Interconnection Tunnel: Stainless Steel mesh wires with end Flanges
- Nest swing 'rosette': Zinc plated steel ring wrapped with steel core rope braided with polypropylene. Seat made of steel-rope chain-link mat. The suspension ropes are made with steel core rope braided with polypropylene ending with a stainless-steel chain on the top end to adjust the suspension length. The shackles are made in high-quality stainless steel. All of the clip rings are made in aluminum
- Web-nets: Stainless steel ropes meshed together with stainless steel sleeves. The whole apparatus placed in a stainless-steel frame consists of circular tubes with stainless steel plates attached to fit into the metal frames
- Steel Ropes apparatus: Steel core ropes braided with polypropylene (DIA 16mm). Solid and aesthetic connectors made of injection molded durable plastic / end-connectors and sleeves made of durable aluminum alloy
- All other plastic elements: Fiber reinforced plastic
- Transparent Parts: Clear Polycarbonate material (t=5mm)
- Rest Inner Activities: EPDM rubber mats with reinforce inlays.

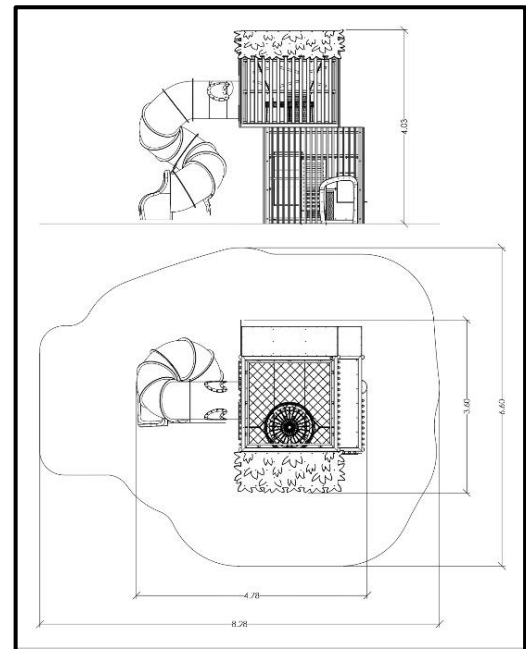

Please note that the above list of materials concerns the articles of the whole series. Therefore, some of them are not used in the described article.